

cecotec

BOLERO FLUX PM 606500 INOX A

BOLERO FLUX PM 606500 BLACK A

Campana extractora piramidal / Pyramidal extractor hood

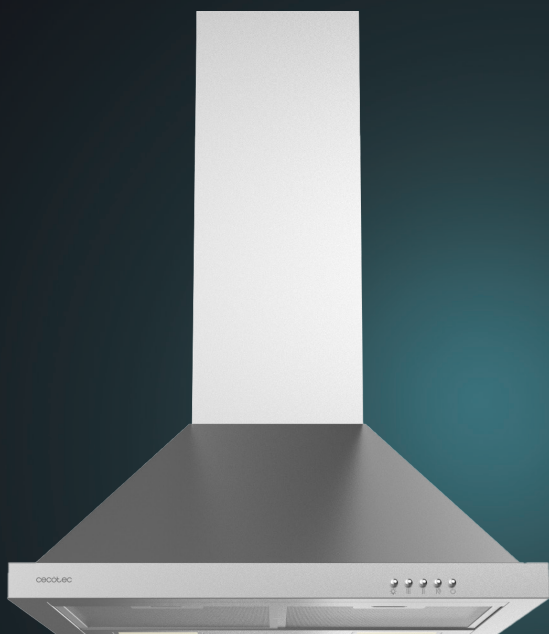

bolero

Manual de instrucciones
Instruction manual
Manuel d'instructions
Bedienungsanleitung
Manuale di istruzioni
Manual de instruções
Handleiding
Instrukcja obsługi
Návod k použití

1. PARTS AND COMPONENTS

Fig. 1

1. Off button
2. Low power button
3. Medium power button
4. High power button
5. Light button

NOTE:

the graphics in this manual are schematic representations and may not exactly match the device.

2. BEFORE USE

- This appliance is packaged in a way as to protect it during transport. Take the device out of its box and remove all packaging materials. You can keep the original box and other packaging elements in a safe place. This will help you prevent damage to the device when transporting it in the future. In case the original packaging is disposed of, make sure all packaging materials are recycled accordingly.
- Make sure all parts and components are included and in good conditions. If there is any piece missing or in bad conditions, contact the official Cecotec Technical Support Service immediately.

Box content

- Kitchen hood
- Assembly kit
- Instruction manual

3. INSTALLATION

Figure 2 shows the dimensions of the kitchen hood required for installation.

- Before installing the kitchen hood, make sure that the area is clean to prevent it from sucking in dust or dirt.
- Please note that the kitchen hood must not share the same ventilation duct with other appliances that use gas or other fuses.
- To facilitate air outlet, the ventilation duct should have a curvature of $\geq 120^\circ$ and should be connected to the outside wall.

ENGLISH

- After installation, ensure that the kitchen hood is level to prevent grease build-up on the end. Fig. 3
- 1. The kitchen hood should be placed at a distance of 65-75 cm above the cooking surface for best effect.
- 2. Install the wall hook in a suitable location and set the installation height. Keep it aligned. Use the screws to fix it to the wall. Fig. 4
- 3. Fix the outer bracket on the chimney, Fig 5, and make sure that the inner part of the chimney can be adjusted to the installation height, as well as that of the flexible connection pipe. Then, install the flexible connection pipe in the chimney of the kitchen hood. Fig. 6
- 4. Place the kitchen hood on the hook on the wall. Fig. 7
- 5. Adjust the height of the inner part of the chimney to the position of the inner bracket and fix it with screws (ST4*8 mm). After adjusting the position of the kitchen hood, fix the body with safety screws (ST4*30 mm). Fig. 8

Note: There are two safety ventilation ducts in the back housing.

4. OPERATION

Power buttons

1. To switch on the kitchen hood, press any of the power buttons.
2. If you press the low power button, the kitchen hood will beep, and the motor will operate at low speed.
3. If you press the medium power button, the kitchen hood will beep, and the motor will operate at medium speed.
4. If you press the high-power button, the kitchen hood will beep, and the motor will operate at high speed.
5. If you press the light button, both bulbs will light up. Press it again and the light will switch off.
6. Press the off button, the motor will switch off.

5. CLEANING AND MAINTENANCE

Cleaning aluminium filters

Do not use corrosive detergents to clean grease from the aluminium filters. Regular cleaning of the aluminium filters will prolong the life of the appliance and keep it in good working order. Figure 9 shows how to release the filter from the kitchen hood. Follow the instructions below:

Cleaning method

1. Immerse the aluminium filters in hot water (40-50 °C), add neutral detergent and let them soak for 2 to 3 minutes. Protect yourself with gloves and clean the filters with a soft brush or scouring pad. Do not apply too much force, as filters are very delicate and can be easily damaged.
2. If you wish, you can also wash the filters in the dishwasher at a temperature of approx. 60 °C.

Cleaning

- Always switch off the power supply before cleaning or performing any maintenance work on the kitchen hood.
- To prevent the outer surface of the kitchen hood from deteriorating over time, it is recommended that it be cleaned with hot water and a non-corrosive detergent every two months.
- Do not use abrasive detergents. Otherwise, the surface of the kitchen hood may be damaged.
- Keep the motor and other parts away from water, as water may damage the appliance.
- The carbon filter must not be exposed to heat.

Carbon filter

This type of filter has activated carbon and purifies air and absorbs cooking odours. The activated carbon becomes saturated after a period of time, which will reduce the adsorption capacity of the filter. The carbon filter cannot be washed nor cleaned in any way.

When the kitchen hood is used regularly, the activated carbon filter should be replaced according to the frequency of use. If frying more frequently, shorten this interval.

1. Remove the aluminium filters.
 2. The carbon filters are located on both sides of the motor. Turn the filters, until they are firmly in place.
 3. To replace the carbon filter, proceed in reverse order.
- Fig. 10

Replacing the light bulb/lamp

Please note:

- The light bulb must be replaced by the official Cecotec Technical Support Service or similarly qualified technicians.
- Always disconnect the power supply before performing any operation on the appliance. When handling the bulb, make sure that it has cooled down completely before any direct contact with your hands.
- When handling the bulbs, hold them with a cloth or gloves to prevent sweat from coming into contact with the bulb, as this may reduce the bulb life.

Note:

- Before changing the light bulb, make sure that the appliance is switched off and unplugged.
- Protect yourself from danger when changing the light bulb, e.g., by wearing gloves.
- Technical data of the light bulb/lamp: 220 V AC – 1.5 W

6. TROUBLESHOOTING

Problem	Cause	Solution
The light is on, but the motor does not work	The kitchen hood is obstructed.	Remove what is obstructing the hood.
	The condenser is damaged.	Replace the condenser.
	Motor is jammed or bearing damaged.	Replace the motor.
	Motor is burnt or gives off a bad smell.	Replace the motor.
Neither the light bulb nor the motor works	In addition to the above, check the following:	
	The light bulb has blown.	Replace the light bulb.
	Power cable is loose.	Connect the cables according to the wiring diagram.
Grease falls out of the aluminium filters	The filters are very dirty.	Clean or replace the aluminium filters immediately.
The kitchen hood vibrates	The fan is damaged, causing the kitchen hood to vibrate when extracting air.	Replace the fan.
	The engine is not securely fastened.	Fix the engine correctly.
	The kitchen hood is not securely fastened.	Fix the kitchen hood correctly.
The kitchen hood is not sufficiently extracting	The distance between the kitchen hood and the cooking surface is too large.	Readjust the distance.
	There is too much ventilation in the room due to open doors or windows.	Relocate and reinstall the kitchen hood.

The kitchen hood is tilted	Fastening screws are not tightened properly.	Reposition the kitchen hood horizontally and tighten the screws.
	Plastic plugs are not tightened properly.	Reposition the kitchen hood horizontally and tighten the plugs.

7. TECHNICAL SPECIFICATIONS

Product reference: 02870/02871
Product: Bolero Flux PM 606500 Inox A/Bolero Flux PM 606500 Black A

Rated voltage: 220-240 V~
Rated frequency: 50 Hz
Total power: 168 W
Motor power: 165 W
Air flow: 650 m³/h
Lamp type: rectangular LED light, 2x1.5W
Lamp dimensions: 120x33 mm
ILCOS D: DBL-1.5-S-120/33

This appliance features a light source with an energy efficiency grade A.

The appliance power consumption when off is 0 W, following the guidelines of EN 50564:2011 and the European regulations 1275/2008/EC and 801/2013/EC. The appliance doesn't perform any function when connected to the mains. The switch/controller of the appliance was set to the Off position.

	Symbol	Value	Unit
Model identification		02870 02871	
Annual energy consumption	AEC _{hood}	36.0	kWh/a
Time increment factor	f	0.9	
Fluid dynamic efficiency	FDE _{hood}	30.3	

Energy Efficiency Index (EEIW)	EEI_{hood}	48.9	
Measured airflow at maximum efficiency point	Q_{BEP}	328.3	m ³ /h
Air pressure measured at maximum efficiency point	P_{BEP}	328	Pa
Maximum airflow	$Q_{m\acute{a}x}$	621.71	m ³ /h
Electrical input power measured at maximum efficiency point	W_{BEP}	110.4	W
Nominal power of the lighting system	W_L	3	W
Measured illumination of the illumination system on the cooking surface	E_{med}	52	lux
Standby power consumption	P_s	-	W
Power consumption in off mode	P_O	0	W
Noise level (High setting)	L_{WA}	69	dB
Noise level (Low setting)	L_{WA}	61	dB

Technical specifications may change without prior notification to improve product quality.
Made in China | Designed in Spain

8. DISPOSAL OF OLD ELECTRICAL AND ELECTRONIC APPLIANCES



This symbol indicates that, according to the applicable regulations, the product and/or batteries must be disposed of separately from household waste. When this product reaches the end of its shelf life, you should dispose of the cells/batteries/accumulators and take them to a collection point designated by the local authorities.

Consumers must contact their local authorities or retailer for information concerning the correct disposal of old appliances and/or their batteries.

Compliance with the above guidelines will help protecting the environment.

9. TECHNICAL SUPPORT AND WARRANTY

Cecotec shall be liable to the end user or consumer for any lack of conformity that exists at the time of delivery of the product under the terms, conditions, and deadlines established by the applicable regulations.

It is recommended that repairs be carried out by qualified personnel.

If at any moment you detect any problem with your product or have any doubt, do not hesitate to contact the official Cecotec Technical Support Service at +34 96 321 07 28.

10. COPYRIGHT

The intellectual property rights over the texts in this manual belong to CECOTEC INNOVACIONES, S.L. All rights reserved. The contents of this publication may not, in whole or in part, be reproduced, stored in a retrieval system, transmitted, or distributed by any means (electronic, mechanical, photocopying, recording or similar) without the prior authorization of CECOTEC INNOVACIONES, S.L.

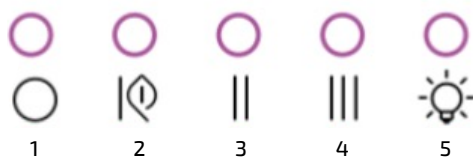

Fig./Img./Abb./Afb./ Rys. 1

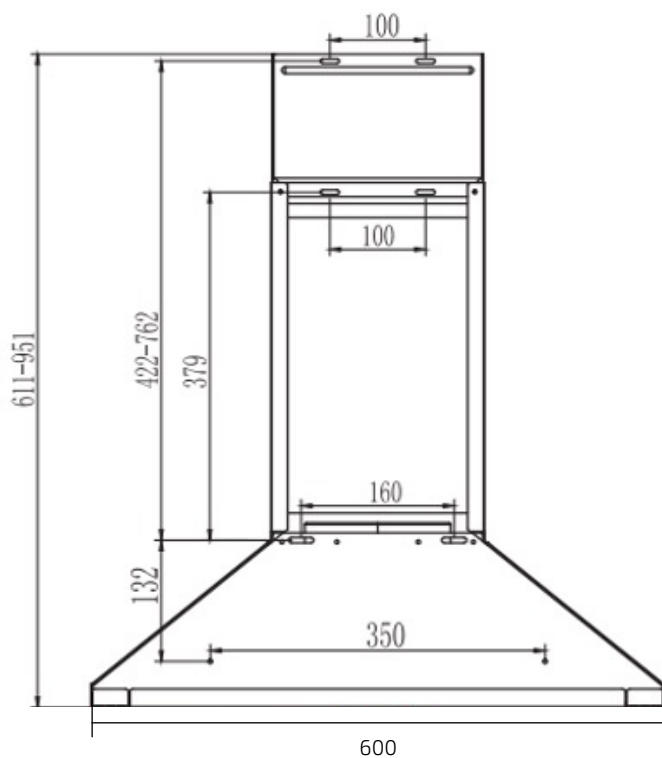

Fig./Img./Abb./Afb./ Rys. 2

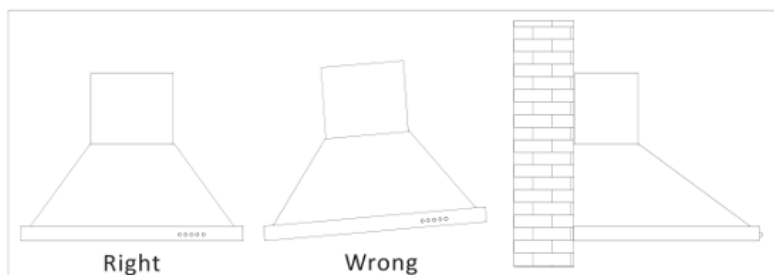

Fig./Img./Abb./Afb./ Rys. 3

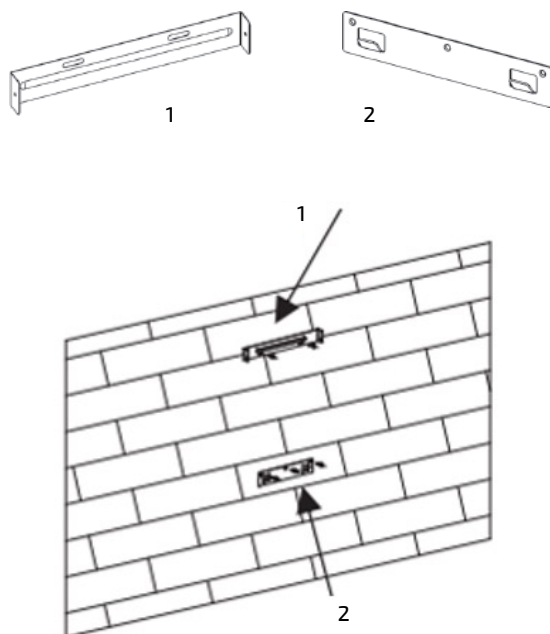
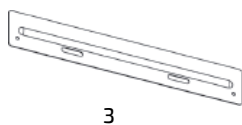
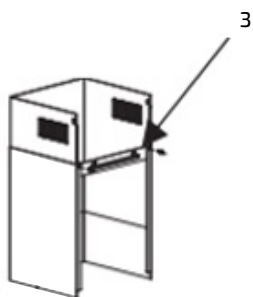

Fig./Img./Abb./Afb./ Rys. 4



3



3

Fig./Img./Abb./Afb./ Rys. 5

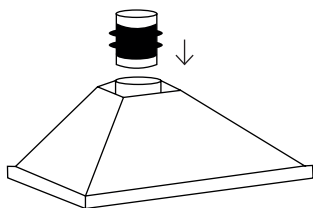

Fig./Img./Abb./Afb./ Rys. 6

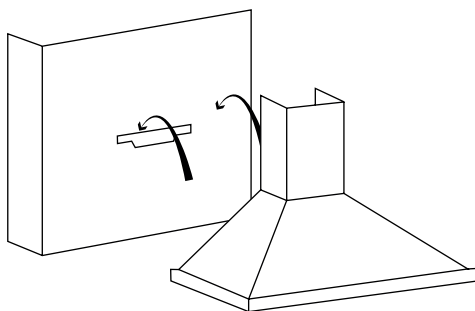

Fig./Img./Abb./Afb./ Rys. 7

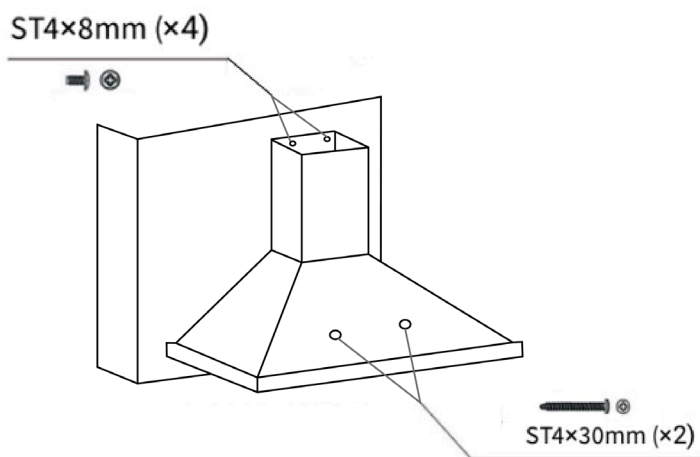

Fig./Img./Abb./Afb./ Rys. 8

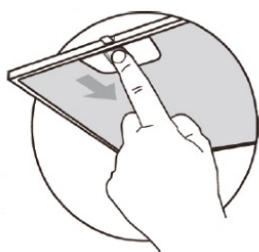

Fig./Img./Abb./Afb./ Rys. 9

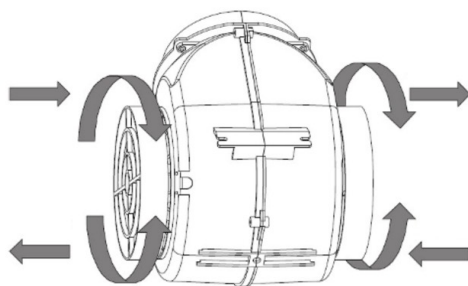

Fig./Img./Abb./Afb./ Rys. 10

www.cecotec.es

Cecotec Innovaciones S.L.
Av. Reyes Católicos, 60
46910, Alfafar (Valencia)
AP01230926